

# Service Replacement Parts

## 10"x21/4" Electric Brake

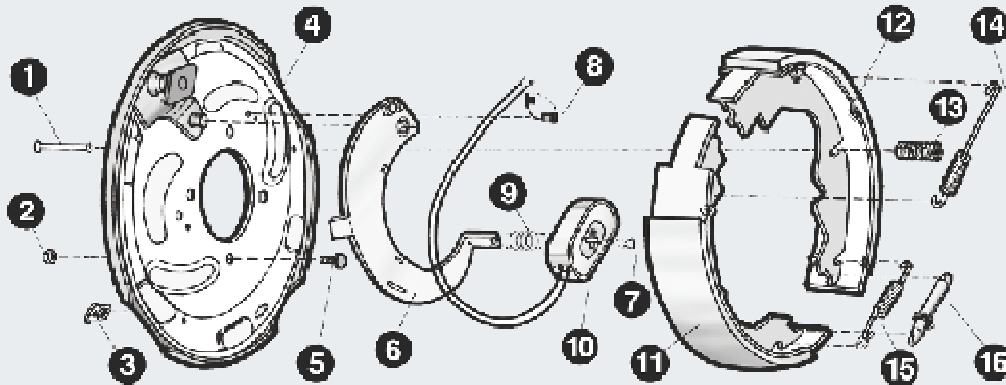

2,200 - 3,500lb.



### Parts List

No.	Brake Part Description	AL-KO Part No.	Hayes Part No.	No.	Brake Part Description	AL-KO Part No.	Hayes Part No.
0	RH Brake Assembly Complete	363383.1	60202703	10	Magnet Assembly (Green Wire)	K568119	M144
0	LH Brake Assembly Complete (Shown)	363383.2	60202803	11	Primary Shoe & Lining	K568112	SL110
1	Shoe Hold Down Pin	568094	09661104	11	Primary Shoe & Lining (Parking Brake)	568173	—
2	Brake Mounting Nut 7/16" - 20	363312	090616	12	Secondary Shoe & Lining	K568112	SL110
3	Plug, Adjuster Slot	568089	096932	12	Secondary Shoe & Lining (Parking Brake)	568174	—
4	Backing Plate Assembly	—	—	13	Shoe Hold Down Cup & Spring	568093	10443
5	Brake Mounting Stud (7/16" - 20)	363900	090762	14	Shoe Retract Spring	568097	09650603
6	RH Lever Assembly	568121	60283001	15	Adjuster Screw Spring	568095	096526
6	LH Lever Assembly (Shown)	568122	60282901	16	Adjuster Screw Assembly	568110	60272401
7	Clip, Wire & Magnet	568092	09680815	16	Adjuster Screw Socket	568086	60272801
8	Strain Relief (Magnet Wire)	568090	092715		Magnet Wire Loom	5683371	
9	Magnet Spring	568103	096522				

**WARNING:** AL-KO Kober Corporation manufacture hubs and drums that are compatible with many wheels used in the trailer industry that have matching bolt patterns. AL-KO does not manufacture wheels, nor do they recommend a specific wheel for compatibility with the hubs and drums they manufacture. The wheel manufacturer should be contacted for proof of compatibility before use.